

Technical features:

- steel towel radiator
- horizontal elements 25x20 mm rectangular steel tubes
- side square collectors 30x30 mm section
- manifolds threading 1/2" Gas right
- maximum working pressure of 4 bar
- maximum working temperature 95°C
- hydraulic radiator equipped with a booster mounted behind the radiator with a power of 1,000 watts.
- not suitable for installation with a single-pipe system

Price included:

- 4 wall fixing in the same color as the radiator
- 2 1/2" hidden air vents complete with valve cover

Finishes available	Surcharge
Standard White	
Classic finished	
Special finished	
Other RAL colors	

Finishing codes see page 596.

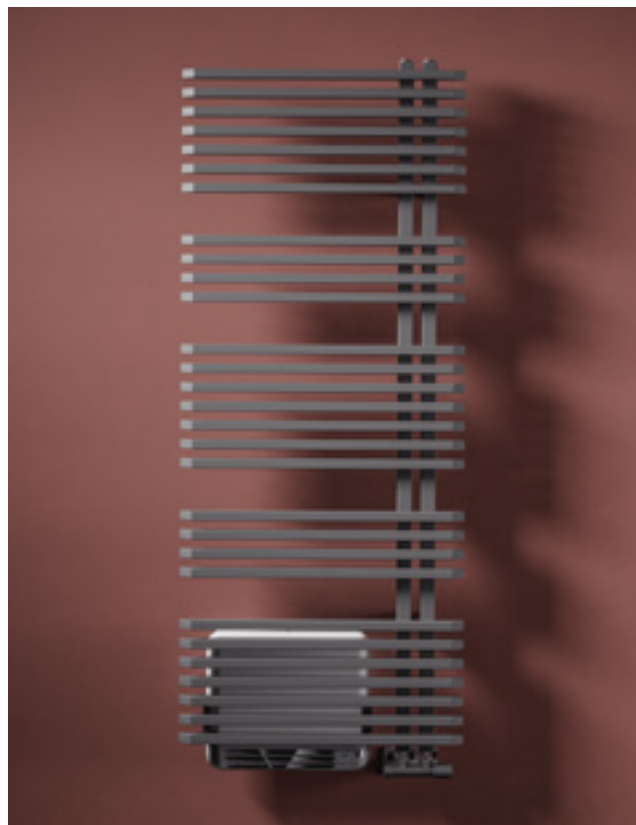

50 mm Connection

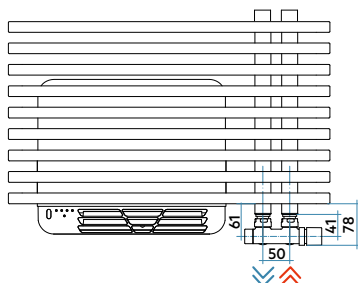

Type with collectors on the right
Hydraulic connection 50 mm

Connection dimensions with IRSAP valves

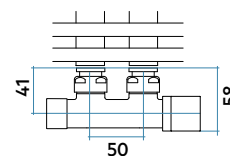

Booster



MAIN CHARACTERISTICS OF AIR DIFFUSER

- ON/OFF switch
- Power supply 230 V 50 Hz, 1 ph
- Power installed = 1000 W
- Insulation: CLASSE II
- Connecting to a network equipment that comes with the phase and neutral version without plug or with Schuko plug
- Protection index: IP24
- Long electricity cable: 1.200 mm
- Electronic ambient thermostat

JAZZ_S AIR MIX

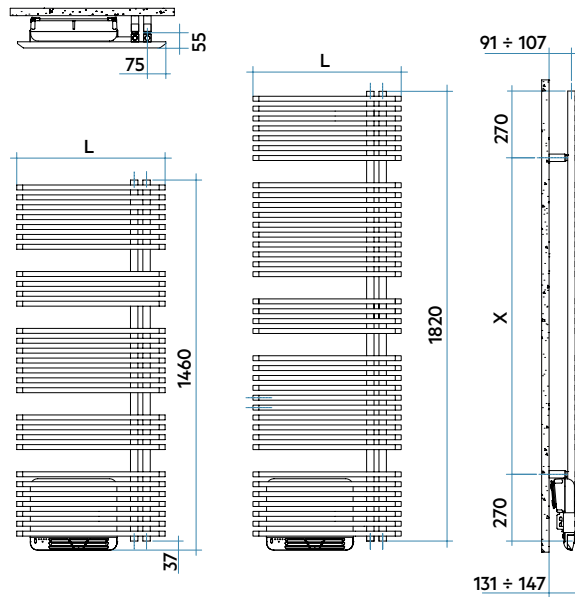

L mm	H mm	X mm
600	1460	920
600	1820	1280



Model	Code	Depth P mm	Height H mm	Width L mm	Conn. C. L' mm	Weight Kg	Cap. lt	Thermal Power				Exp. n.	Auxiliary heater	
								$\Delta t=50^{\circ}\text{C}$	$\Delta t=40^{\circ}\text{C}$	$\Delta t=30^{\circ}\text{C}$	$\Delta t=20^{\circ}\text{C}$		with diffuser	Watt
1460 29 rails 4 espaces	ZBL060 B 01 IR 01 NNN	124	1497	600	50	21,1	7,5	2494	731	557	392	239	1,219	+ 1000
1820 38 rails 4 espaces	ZBG060 B 01 IR 01 NNN	124	1857	600	50	26,5	9,7	3103	909	688	479	288	1,253	+ 1000

(*) Thanks to the high performance of Irsap JAZZ_S AIR MIX radiators, the ideal Δt for low temperature projects is Δt at 30°C .
For Δt different from 50°C use the formula: $Q=Q_n (\Delta t / 50)^n$

Key Codes

Width		Standard White colour code - for different colour codes see the colors page	
ZB	L	060	B
Height		Packing code	
01	IR	01	NNN
		Standard hydraulic code connection	

Decorative & Technical Accessories

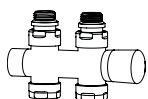

Kit Valves and
Lockshield valve
Pag. 562

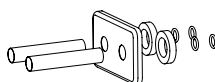

Pipe cover kit
Pag. 566

Wireless Remote Control for booster control

JAZZ_S Air Mix is equipped with a wireless controller that allows remote management of every electric radiator function. Because the controller is wireless, it has the advantage of being quick and easy to install and does not require any modifications within the home.

REELETRAS2501N

Technical specifications

- Wireless communication via radio signals transmitted to the receiver connected to the system.
- Approx. 30-50 metre range in residential environments (868 MHz).
- Radiofrequency communication pursuant to European standards.
- You can activate the manual functions

